



Installation Guide For HyPanel Pro



smarter home |
sweeter life

Welcome

This guide applies to the following models of HyPanel Pro:
PG71-PoE-EU and PG71N-PoE-EU.

Contents

Before We Start	2
In the Box	3
Check Compatibility	4
Wiring	7
Installation	10
Get Help	14

Before We Start

Your first time installing this product may take up to 40 minutes.
You'll get faster after each installation.

WARNING

Keep the device and all its parts out of the reach of children.
The small parts or accessories contained may be a choking
hazard to them.



In The Box

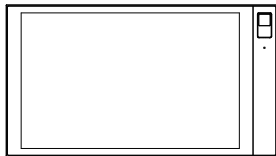

HyPanel Pro x1

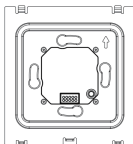

Flush Mounted Module x1



M4x20mm Phillips Machine Screw x2

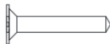

M3x20mm Phillips Self Tapping Screw x2



Hex Key x1

Check Compatibility

Product dimensions

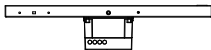

⑤ BOTTOM VIEW

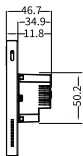

② RIGHT VIEW

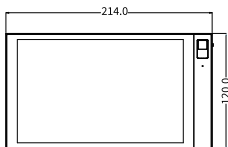

① FRONT VIEW



③ LEFT VIEW

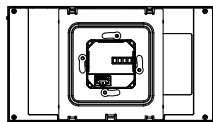

④ BACK VIEW

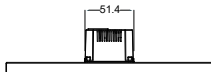

⑥ TOP VIEW

Working space

Make sure the HyPanel Pro is compatible with the location where you want to install it.

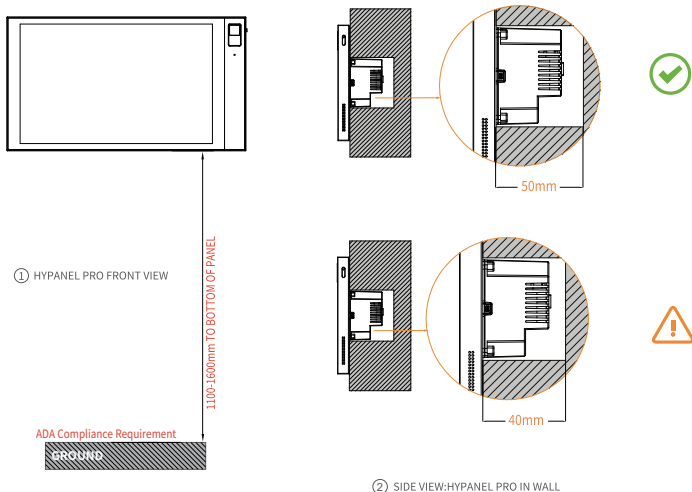

A 50mm(2 inches) deep electrical box is highly recommended for ease of installation. In some scenarios, especially when the wires can be pushed back into the wall far enough, it may be possible to use a 40mm(1.6 inches) deep box.

PoE or DC power input

HyPanel Pro can be powered by either IEEE802.3af standard PoE or 12-24V DC.

Support Wi-Fi and Ethernet connections

HyPanel Pro can operate with both wireless and wired networks, but we highly recommend using wired networks if you want to remotely control the device via the BelaHome App or perform updates.

Wiring

Identify wires

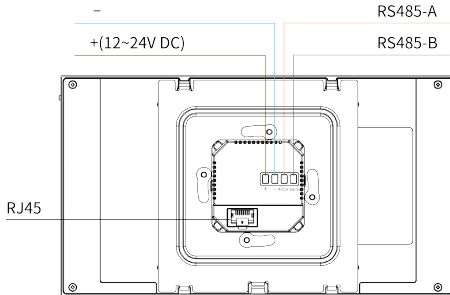

- A positive DC wire(+) is often brown or red, and provides 12 -24 Volts of power to the device.
- A negative DC wire(-) is often blue or black.
- The RJ45 cable connecting with a PoE switch carries both data and power to the device, while the RJ45 with a non-PoE switch provides only Ethernet.
- RS485_A and RS485_B are two signal lines used to connect third-party devices to HyPanel Pro. NO need to connect to these two terminals if you' re not using third-party devices with RS485 communications.

Connect wires

- Strip and straighten wires



The wires used for 12-24V DC power supplier or RS485 communication should be 1.5mm² ~ 2.5mm² in size and have stripped and straight ends. Strip the wires by removing the plastic sheathing, and make sure the exposed wire ends measure approximately 8 mm (5/16 inch) in length.

- Connect all wires

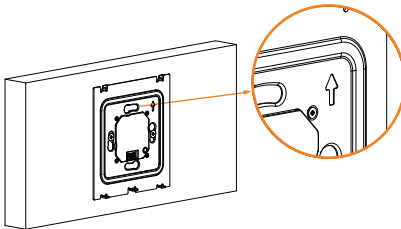

Always make sure the arrow on the front of the flush mounted module is pointing up.

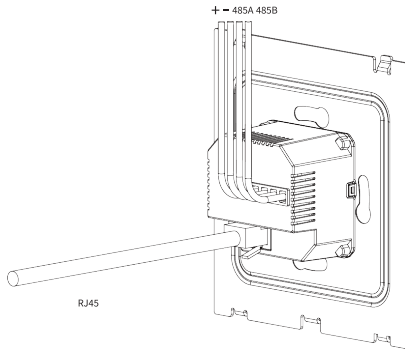

- If you want to power the device using PoE
Plug the RJ45 Ethernet cable to the PoE port so that the module can receive both data and power.
- If you want to power the device with 12-24V DC
 - Plug the positive and negative DC wires to the corresponding terminals respectively.
 - Tighten the screws at the bottom clockwise with a flat-head screwdriver until wires are secure.
 - Double check by gently tugging on each wire.
- If you need to connect to third-party devices over RS485
Connect RS485_A and RS485_B wires to the corresponding terminals respectively.

Installation

1. Select screws

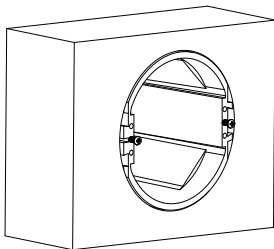

- Select the proper screws fitting your electrical box.
- Change the torque on the electric screwdriver to 5kgf.cm.
- Turn screws clockwise with the screwdriver.
- Do not fully tighten the screws. The screw head must protrude at least 3 mm (1/8 inch) from the wall surface.

2.Install flush mounted module

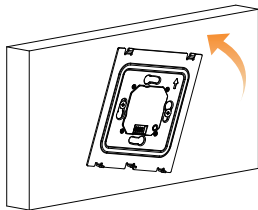

- Attach the flush mounted module to the electrical box. The screws should go through the holes on the module.

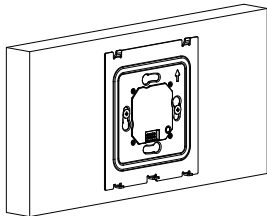

- Adjust the module to be level and ensure it is flush against the wall.
- Tighten the screws to attach the module to the wall, taking care not to over-tighten them.

3. Install panel

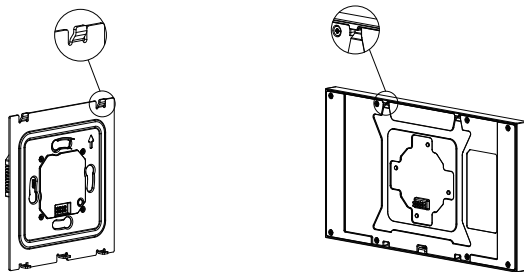

Line up the two clips on the flush mounted module with the notches on the panel.
Snap the panel into place and press it down.

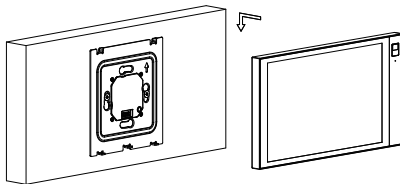

- Check the panel is properly clipped onto the module and is flush against the wall.
- Locate the screw hole on the bottom of the panel. There is a screw already in it.
- Tighten the screw with the included hex key.

If you need to remove the panel

We strongly recommend detaching a panel from the screwing side.

1. Turn the screw with the hex key until the rear edge of the panel come loose.
2. Press one hand above the panel on the top, and then grab and pull out the panel with the other hand from the bottom edge.

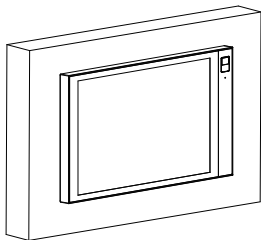

①

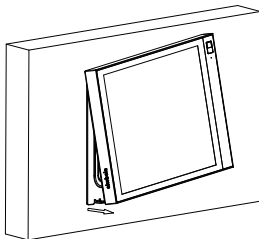

②

Congratulations!

You are done with the HyPanel Pro installation!

Start your smart home journey with akubela now!

Get Help

For help or more assistance,
contact us at: <https://ticket.akuvox.com/>

For videos, guides, and additional product formation,
visit us at: <https://knowledge.akuvox.com>



YS71000009